



Imaged Document Cover Sheet

CITY OF MARIBYRNONG

RECEIVED

16/09/2024

URBAN PLANNING

**CITY OF MARIBYRNONG
ADVERTISED PLAN**

The document following this cover sheet is an imaged document supplied by LANDATA®, Secure Electronic Registries Victoria.

Document Type	Plan
Document Identification	TP601873Y
Number of Pages (excluding this cover sheet)	1
Document Assembled	16/09/2024 14:06

Copyright and disclaimer notice:

© State of Victoria. This publication is copyright. No part may be reproduced by any process except in accordance with the provisions of the Copyright Act 1968 (Cth) and for the purposes of Section 32 of the Sale of Land Act 1962 or pursuant to a written agreement. The information is only valid at the time and in the form obtained from the LANDATA® System. None of the State of Victoria, LANDATA®, Secure Electronic Registries Victoria Pty Ltd (ABN 86 627 986 396) as trustee for the Secure Electronic Registries Victoria Trust (ABN 83 206 746 897) accept responsibility for any subsequent release, publication or reproduction of the information.

The document is invalid if this cover sheet is removed or altered.

TITLE PLAN	EDITION 1	TP 601873Y
------------	-----------	------------

<p>Location of Land</p> <p>Parish: CUT-PAW-PAW</p> <p>Township:</p> <p>Section: CITY OF MARIBYRNONG</p> <p>Crown Allotment: ADVERTISED PLAN</p> <p>Crown Portion:</p> <p>Last Plan Reference: LP 4631</p> <p>Derived From: VOL 3490 FOL 821</p> <p>Depth Limitation: NIL</p>	<p>Notations</p> <p>ANY REFERENCE TO MAP IN THE TEXT MEANS THE DIAGRAM SHOWN ON THIS TITLE PLAN</p>
---	--

<p>Description of Land / Easement Information</p> <p><u>ALL THAT</u> piece of land delineated and coloured red on the map -- in the margin being part of Lots 43 and 44 on Plan of Subdivision No.4631- -- Parish of Cut Paw Paw County of Bourke Together with a right of - - - - - carriageway over the roads coloured brown on the said Plan of Subdivision- -- and Together with a right of carriageway over the roads coloured brown on -- Plan of Subdivision No.4638 and Together with the right to use the said- --- roads on Plan of Subdivision No.4638 for drainage purposes and also the - - - right to use all sewers drains and watercourses over under and along the same</p>	<p>THIS PLAN HAS BEEN PREPARED FOR THE LAND REGISTRY, LAND VICTORIA, FOR TITLE DIAGRAM PURPOSES AS PART OF THE LAND TITLES AUTOMATION PROJECT</p> <p>COMPILED: 15/08/2000</p> <p>VERIFIED: AC</p>
---	---

COLOUR CODE
R = RED

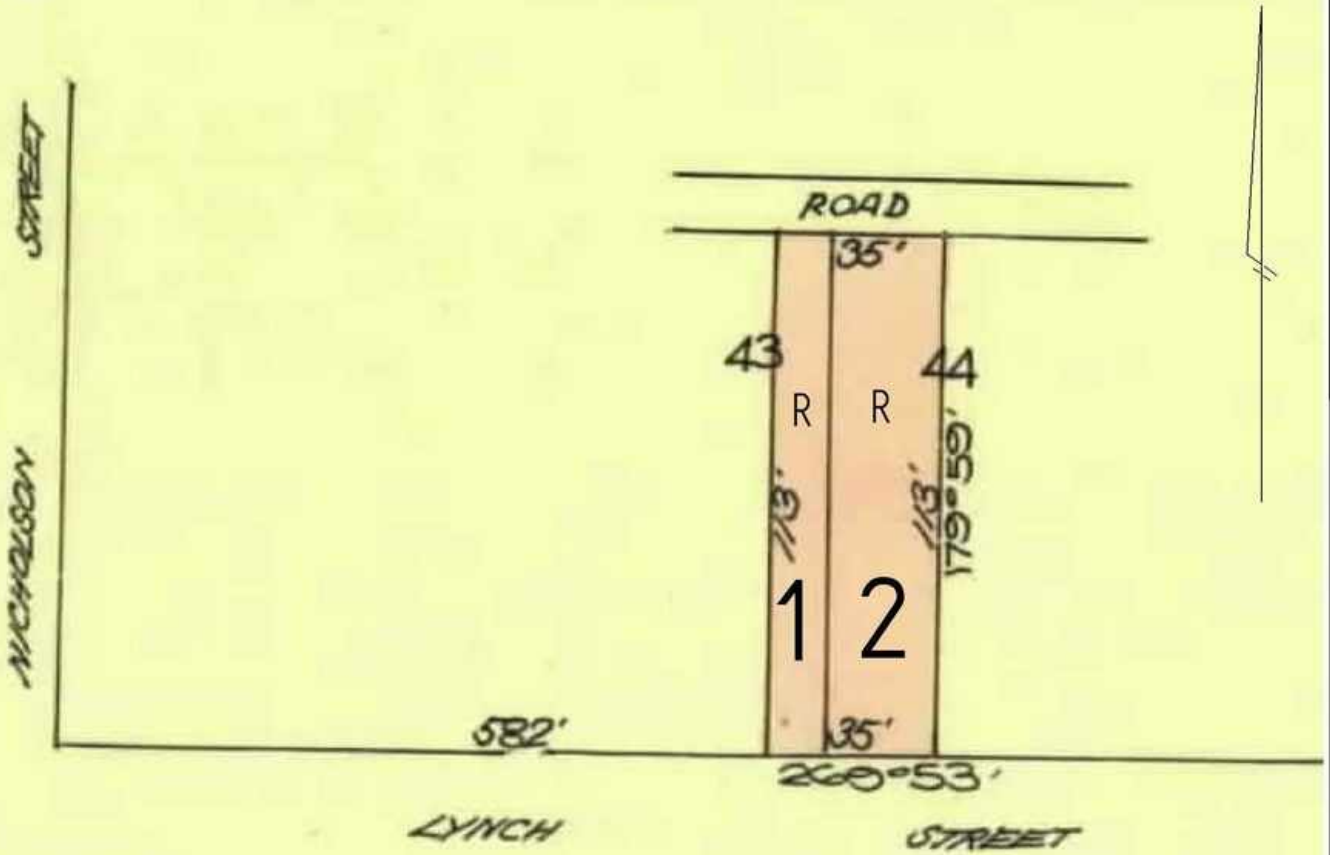

TABLE OF PARCEL IDENTIFIERS
WARNING: Where multiple parcels are referred to or shown on this Title Plan this does not imply separately disposable parcels under Section 8A of the Sale of Land Act 1962
PARCEL 1 = LOT 43 (PT) ON LP 4631
PARCEL 2 = LOT 44 (PT) ON LP 4631