

Copyright State of Victoria. No part of this publication may be reproduced except as permitted by the Copyright Act 1968 (Cth), to comply with a statutory requirement or pursuant to a written agreement. The information is only valid at the time and in the form obtained from the LANDATA REGD TM System. None of the State of Victoria, its agents or contractors, accepts responsibility for any subsequent publication or reproduction of the information.

The Victorian Government acknowledges the Traditional Owners of Victoria and pays respects to their ongoing connection to their Country, History and Culture. The Victorian Government extends this respect to their Elders, past, present and emerging.

REGISTER SEARCH STATEMENT (Title Search) Transfer of Land Act 1958

VOLUME 09232 FOLIO 430

Security no : 124104686318B
Produced 16/03/2023 10:17 AM

LAND DESCRIPTION

Land in Plan of Consolidation 106562.

PARENT TITLES :

Volume 06451 Folio 015 Volume 06828 Folio 579

Created by instrument CP106562 17/10/1977

REGISTERED PROPRIETOR

Estate Fee Simple

Sole Proprietor

WATTYL AUSTRALIA PTY LTD of 48 WALKER STREET FIVE DOCK NEW SOUTH WALES
L604228H 04/04/1985

ENCUMBRANCES, CAVEATS AND NOTICES

COVENANT 1473391

Any encumbrances created by Section 98 Transfer of Land Act 1958 or Section 24 Subdivision Act 1988 and any other encumbrances shown or entered on the plan or imaged folio set out under DIAGRAM LOCATION below.

DIAGRAM LOCATION

SEE CP106562 FOR FURTHER DETAILS AND BOUNDARIES

ACTIVITY IN THE LAST 125 DAYS

NIL

-----END OF REGISTER SEARCH STATEMENT-----

Additional information: (not part of the Register Search Statement)

Street Address: 2 GRAINGERS ROAD WEST FOOTSCRAY VIC 3012

DOCUMENT END

Delivered from the LANDATA® System by GlobalX Pty Ltd

Copyright State of Victoria. No part of this publication may be reproduced except as permitted by the Copyright Act 1968 (Cth), to comply with a statutory requirement or pursuant to a written agreement. The information is only valid at the time and in the form obtained from the LANDATA REGD TM System. None of the State of Victoria, its agents or contractors, accepts responsibility for any subsequent publication or reproduction of the information.

The Victorian Government acknowledges the Traditional Owners of Victoria and pays respects to their ongoing connection to their Country, History and Culture. The Victorian Government extends this respect to their Elders, past, present and emerging.

REGISTER SEARCH STATEMENT (Title Search) Transfer of Land Act 1958

VOLUME 09505 FOLIO 388

Security no : 124104686332M
Produced 16/03/2023 10:17 AM

LAND DESCRIPTION

Lot 1 on Title Plan 815806W.
PARENT TITLE Volume 06103 Folio 526
Created by instrument K223727 07/01/1983

REGISTERED PROPRIETOR

Estate Fee Simple
Sole Proprietor
WATTYL AUSTRALIA PTY LTD of 48 WALKER STREET FIVE DOCK NEW SOUTH WALES
L604226P 04/04/1985

ENCUMBRANCES, CAVEATS AND NOTICES

COVENANT 1640740

Any encumbrances created by Section 98 Transfer of Land Act 1958 or Section 24 Subdivision Act 1988 and any other encumbrances shown or entered on the plan set out under DIAGRAM LOCATION below.

DIAGRAM LOCATION

SEE TP815806W FOR FURTHER DETAILS AND BOUNDARIES

ACTIVITY IN THE LAST 125 DAYS

NIL

-----END OF REGISTER SEARCH STATEMENT-----

Additional information: (not part of the Register Search Statement)

Street Address: 2 GRAINGERS ROAD WEST FOOTSCRAY VIC 3012

DOCUMENT END

Delivered from the LANDATA® System by GlobalX Pty Ltd

© State of Victoria. This publication is copyright. No part may be reproduced by any process except in accordance with the provisions of the Copyright Act 1968 (Cth) and for the purposes of Section 32 of the Sale of Land Act 1962 or pursuant to a written agreement. The information is only valid at the time and in the form obtained from the LANDATA® System. None of the State of Victoria, LANDATA®, Secure Electronic Registries Victoria Pty Ltd (ABN 86 627 986 396) as trustee for the Secure Electronic Registries Victoria Trust (ABN 83 206 746 897) accept responsibility for any subsequent release, publication or reproduction of the information.

CP106562

PLAN OF CONSOLIDATION PART OF CROWN ALLOT 5 SEC 13 PARISH OF CUT PAW PAW COUNTY OF BOURKE  LENGTHS ARE IN METRES	ENCUMBRANCES & NOTATIONS
--	--------------------------

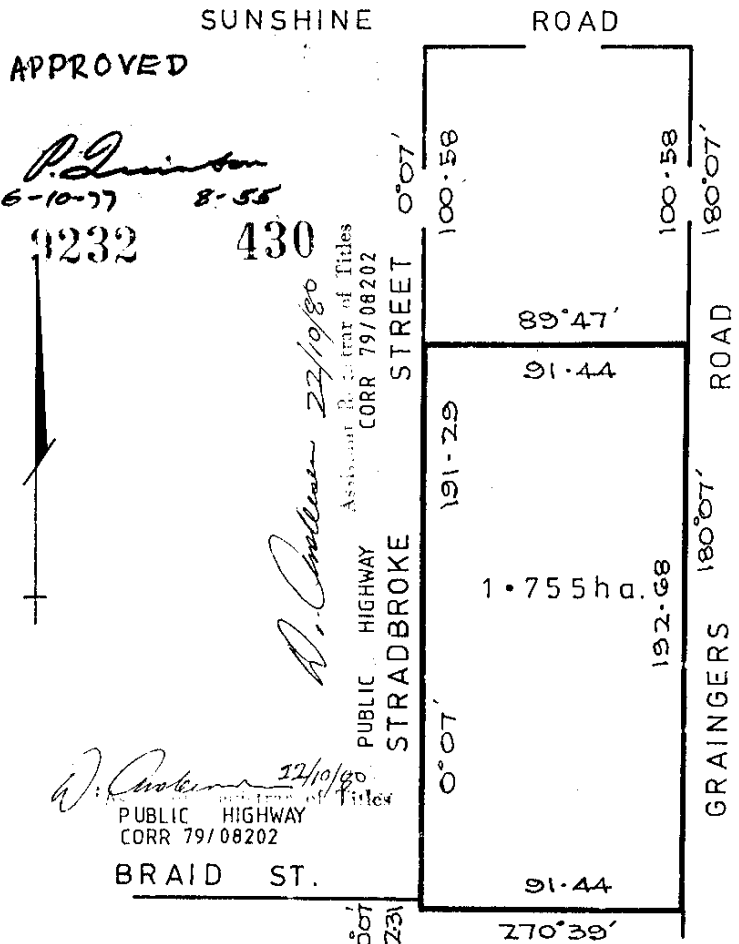

ACCOUNT
 \$20
 2 ct.
 15/8/77

<p>CONSENT OF COUNCIL</p> <p>The Seal of the Council of the City of Footscray was affixed here to pursuant to Section 569 AB of the Local Government Act 1958 in the presence of</p> <p>Mayor <i>M. Henderson</i> Councillor <i>M. Borton</i> Town Clerk <i>[Signature]</i> Date 26th July 1977</p>	<p>SURVEYORS CERTIFICATION</p> <p>I Certify that this plan has been made by me and accords with title and is mathematically correct and <input checked="" type="checkbox"/> based on survey.</p> <p><i>[Signature]</i> Licensed Surveyor.</p> <p>Date 23-5-77</p> <p>F. J. WALTERS & LEA PTY. LTD. CONSULTING ENGINEERS AND SURVEYORS</p> <p>77021 C</p>
--	--

106562

Council Ref ST7/41

© State of Victoria. This publication is copyright. No part may be reproduced by any process except in accordance with the provisions of the Copyright Act 1968 (Cth) and for the purposes of Section 32 of the Sale of Land Act 1962 or pursuant to a written agreement. The information is only valid at the time and in the form obtained from the LANDATA® System. None of the State of Victoria, LANDATA®, Secure Electronic Registries Victoria Pty Ltd (ABN 86 627 986 396) as trustee for the Secure Electronic Registries Victoria Trust (ABN 83 206 746 897) accept responsibility for any subsequent release, publication or reproduction of the information.

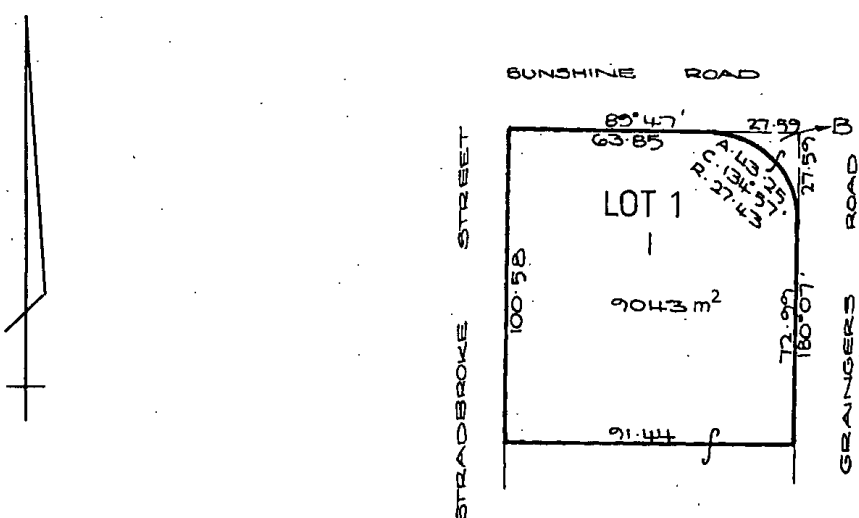
TITLE PLAN		EDITION 1		TP 815806W	
Location of Land Parish : Cut – Paw –Paw Township : -- Crown Allotment : -- Crown Portion : -- Section : -- Last Plan Reference : LP 13264 Title Reference : Vol . 9505 FOL. 388 Depth Limitation : NIL.			Notations Note 1 : Lot 1 hereon formerly part of Lot 1 on LP13264 Note 2 : As to the whole of the land shown hereon TOGETHER with the right of carriageway shown marked B on Certificate of Title Vol. 9505 Fol. 388		
Easement Information					THIS PLAN HAS BEEN PREPARED BY LAND REGISTRY, LAND VICTORIA FOR TITLE DIAGRAM PURPOSES Checked by :  Assistant Registrar of Titles Date 21 / 11 / 2003
E – Encumbering Easement		R – Encumbering Easement (ROAD)		A – Appurtenant Easement	
Easement Reference	Purpose / Authority	Width (Metres)	Origin	Land benefited / In favour of	
 <p style="text-align: center;">MEASUREMENTS ARE IN METRES</p>					
LENGTHS ARE IN METRES	SCALE	SHEET SIZE A3			
Sheet 1 of 1 Sheet					

Titles Office Use Only

REGD

040485 1408 45 \$405 L604228H

Lodged at the Titles Office by

CORRS PAVEY WHITING & BYRNE

Code ~~1373B~~ *0677K*

VICTORIA

TRANSFER OF LAND

registered

Subject to the encumbrances affecting the land including any created by dealings lodged for registration prior to the lodging of this instrument the transferor for the consideration expressed transfers to the transferee all his estate and interest in the fee simple in the land described. (Notes 1-4)

Land

(Note 5)

Certificate of Title Volume 9232 Folio 430

STAMP DUTY VICTORIA
 3TRANS*26612 S.D.V. 4 3APR85
 RECEIPT# 51634 11A \$VVV98,191.50

Consideration

(Note 6)

ONE MILLION SEVEN HUNDRED AND THIRTY-FIVE THOUSAND FOUR HUNDRED AND THIRTY-TWO DOLLARS (\$1,735,432.00)

Transferor

(Note 7)

HARDIE TRADING LIMITED

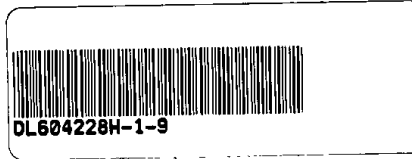

Transferee

(Note 8)

WATTYL AUSTRALIA PTY. LTD. of 48 Walker Street, Five Dock, New South Wales

CODE: <i>04</i>	Date <i>29th</i> day of <i>March</i> 1985.
DUTY: <i>\$9891.50</i>	Execution & Attestation
ASSESSOR: <i>W6</i>	THE COMMON SEAL of HARDIE TRADING LIMITED) was hereunto affixed in accordance with) its Articles of Association and in the) presence of:)
VALUE: <i>\$1,785,300</i>	

Comptroller of Stamps

THE COMMON SEAL of HARDIE TRADING LIMITED)
 was hereunto affixed in accordance with)
 its Articles of Association and in the)
 presence of:)

[Signature]

Director

B. E. Breuss

Director

Secretary



Use Only

THE COMMON SEAL of WATTYL AUSTRALIA PTY. LTD.)
 was hereunto affixed in accordance with)
 its Articles of Association and in the)
 presence of:)

[Signature]

Director

[Signature]

Secretary



T1

Office Use Only



A memorandum of the within instrument has been entered in the Register Book.



29 APR. 1985

REGISTRATION

Approval No. T1/1

NOTES

1. This form must be used for all transfers by the registered proprietor of an estate in fee simple other than
 - (a) transfers by direction
 - (b) transfers creating or reserving easements
 - (c) transfers containing a restrictive covenant or a covenant created pursuant to statute
 - (d) transfers of mortgages charges or leases or leasehold estates
 - (e) transfers of other than the full interest of the transferor for which the appropriate form must be used.
2. Transfers may be lodged as an original only and must be typed or completed in ink.
3. All signatures must be in ink.
4. If there is insufficient space in any panel to accommodate the required information use the above space or an annexure sheet (Form A1). Insert only the words "See Annexure A" (or as the case may be) in the appropriate panel and enter the information above or on the annexure sheet under the appropriate heading.

Multiple annexures may appear on the same annexure sheet but each must be correctly headed.
All annexure sheets should be properly identified and signed by the parties and securely attached to the instrument.
5. Volume and folio references must be given. If the whole of the land in a title is to be transferred no other description should be used. If the transfer affects part only of the land in a title the lot and plan number or Crown description should also be given. Any necessary diagram should be endorsed above or on an annexure sheet (Form A1).
6. Set out the amount (in figures) or the nature of the consideration.
In a transfer on sale of land subject to a mortgage it should be clearly shown whether or not the amount owing under the mortgage is included in the consideration e.g. \$ which includes the amount owing under mortgage No.
7. Insert full name. Address is not required.
8. Insert full name and address. If two or more transferees state whether as joint tenants or tenants in common. If tenants in common specify shares.
9. If an executing party is a natural person execution should read "Signed by the transferor (transferee) in the presence of". The witness must be an independent person. If an executing party is a body corporate execution should conform to any prescribed formalities relating to the affixing of the common seal.

Titles Office Use Only

REGD

040485 1408 45 952 L604226P

Lodged at the Titles Office by

CORRS PAVEY WHITING & BYRNE

Code ~~13738~~ *0677K*

VICTORIA

TRANSFER OF LAND

registered
 Subject to the encumbrances affecting the land including any created by dealings lodged for registration prior to the lodging of this instrument the transferor for the consideration expressed transfers to the transferee all his estate and interest in the fee simple in the land described. (Notes 1-4)

Land (Note 5)

Certificate of Title Volume 9505 Folio 388

STAMP DUTY VICTORIA
 3TRANS+26612 S.D.V. 4 3APR85
 RECEIPT# 51633 11A \$VVV50,016.75

Consideration (Note 6)

NINE HUNDRED AND FIFTY-TWO THOUSAND SIX HUNDRED AND FORTY-SEVEN DOLLARS (\$952,647.00)

Transferor (Note 7)

HARDIE TRADING LIMITED

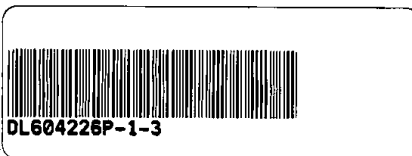

Transferee (Note 8)

WATTYL AUSTRALIA PTY. LTD. of 48 Walker Street, Five Dock, New South Wales

CODE: <i>84</i> DUTY: <i>50,016-75</i> ASSESSOR: <i>W</i> VALUE: <i>\$952,700</i>	Date <i>29th</i> day of <i>March</i> 1985.	Execution & Attestation THE COMMON SEAL of HARDIE TRADING LIMITED) was hereunto affixed in accordance with) its Articles of Association and in the) presence of:	(Note 9)
Controller of Stamps Use Only	 <i>[Signature]</i> Director Director <i>B. E. Brewster</i> Secretary	
		THE COMMON SEAL of WATTYL AUSTRALIA PTY. LTD. was hereunto affixed in accordance with its Articles of Association and in the presence of:	
	 <i>[Signature]</i> Director <i>[Signature]</i> Secretary	

T1 Office Use Only

OFFICE OF TITLES
 VICTORIA

A memorandum of the within instrument has been entered in the Register Book.



NOTES

1. This form must be used for all transfers by the registered proprietor of an estate in fee simple other than
 - (a) transfers by direction
 - (b) transfers creating or reserving easements
 - (c) transfers containing a restrictive covenant or a covenant created pursuant to statute
 - (d) transfers of mortgages or leases or leasehold estates
 - (e) transfers of other than the full interest of the transferor for which the appropriate form must be used.
2. Transfers may be lodged as an original only and must be typed or completed in ink.
3. All signatures must be in ink.
4. If there is insufficient space in any panel to accommodate the required information use the above space or an annexure sheet (Form A1). Insert only the words "See Annexure A" (or as the case may be) in the appropriate panel and enter the information above or on the annexure sheet under the appropriate heading.
Multiple annexures may appear on the same annexure sheet but each must be correctly headed.
All annexure sheets should be properly identified and signed by the parties and securely attached to the instrument.
5. Volume and folio references must be given. If the whole of the land in a title is to be transferred no other description should be used. If the transfer affects part only of the land in a title the lot and plan number or Crown description should also be given. Any necessary diagram should be endorsed above or on an annexure sheet (Form A1).
6. Set out the amount (in figures) or the nature of the consideration.
In a transfer on sale of land subject to a mortgage it should be clearly shown whether or not the amount owing under the mortgage is included in the consideration e.g. \$ which includes the amount owing under mortgage No.
7. Insert full name. Address is not required.
8. Insert full name and address. If two or more transferees state whether as joint tenants or tenants in common. If tenants in common specify shares.
9. If an executing party is a natural person execution should read "Signed by the transferor (transferee) in the presence of". The witness must be an independent person. If an executing party is a body corporate execution should conform to any prescribed formalities relating to the affixing of the common seal.

174886

1473391

BLAKE & RIGGALL

67 To Pitches & Grapes

VICTORIA

TRANSFER OF LAND



IMAGED

20
*Please see register
this transfer is
see index No 3153629*



WE THE TRUSTEES EXECUTORS AND AGENCY COMPANY LIMITED of -
Collins Street Melbourne (as to one equal undivided half part
or share) and EMMA ELIZABETH LE CROISSETTE THOMSON of Burke
Road East Malvern Widow CECIL PERCY THOMSON of Little Collins
Street Melbourne Land Valuer and THE TRUSTEES EXECUTORS AND
AGENCY COMPANY LIMITED of Collins Street Melbourne (as to the
other equal undivided half part or share) being registered as
the proprietors of an Estate in fee simple in the land herein-
after described subject to the encumbrances notified hereunder
in consideration of the sum of Two thousand five hundred pounds
partly to Robert William Kennedy during his lifetime and partly
paid to us (as to one half thereof) to the said The Trustees
Executors and Agency Company Limited and as to the other half
thereof to the said Emma Elizabeth Le Croisette Thomson, Cecil
Percy Thomson and The Trustees Executors and Agency Company
Limited) by REID TRUST PROPRIETARY LIMITED of 581 Little -
Collins Street Melbourne DO HEREBY TRANSFER to the said Reid
Trust Proprietary Limited All our Estate and interest in ALL
THAT piece of land <sup>colored red on the plan above being 10 1/2 and part of 10 acre on plan
of Melbourne 281326 upon the plan above</sup> being part of Crown Allotment 5 Section 13
at West Footscray Parish of Cut Paw Paw County of Bourke being
that part of the land comprised in the Certificates of Title
entered in the Register Book Volume 5599 Folio 1119674 and -
Volume 5599 Folio 1119675 ~~which is colored red on the plan above~~
AND the said Reid Trust Proprietary Limited in considera-
tion of the foregoing Transfer for itself its successors and
transferees registered proprietor or proprietors for the time
being of the land hereby transferred HEREBY COVENANTS with the
said The Trustees Executors and Agency Company Limited and the
said Emma Elizabeth Le Croisette Thomson Cecil Percy Thomson
and The Trustees Executors and Agency Company Limited and their
transferees registered proprietor or proprietors for the time
being of the land remaining untransferred in the said Certifi-
cates of Title that the said Reid Trust Proprietary Limited will
not carry on quarrying operations on the said land hereby trans-
ferred or any part thereof or take or remove any marl stone gravel
or sand therefrom except for the purpose of laying the founda-

*Red
30/1/31
of
29/1/31*

*Red
29/1/31*

*Grand of
Subs*
5599 Sub
674-5 r.p.
area 4-2-6
Lot 14 of photostone
on W. 13264 being
etc
and the lot herein
for
30/1/31
EPs.
SA. 30/1/31
17/31
ending about 11/31

SPS.
[Signature]

tions of any building to be erected on the said land or to be used in the erection of such building or for the purpose of installing storage tanks AND the said Reid ^{Investments} ~~Trust~~ Proprietary Limited HEREBY REQUESTS the foregoing covenant to be notified as an encumbrance on the Certificate of Title to issue in respect of the land hereby transferred.

DATED the *Eighth* day of *December* One thousand nine hundred and thirty

THE COMMON SEAL of THE TRUSTEES
EXECUTORS AND AGENCY COMPANY - -)
LIMITED was hereto affixed by - -)
authority of the Board of Directors)



[Signature] Director
[Signature] General Manager

SPS.
[Signature]

SIGNED in Victoria by the said
EMMA ELIZABETH LE CROISSETTE *Croisette*
THOMSON in the presence of -

E. E. L. Thomson

[Signature]
Bar. Mr. Melbourne

SIGNED in Victoria by the said -)
CECIL PERCY THOMSON in the presence of -)

Cecil P. Thomson

[Signature]

SPS.
[Signature]

THE COMMON SEAL of REID TRUST -
PROPRIETARY LIMITED was hereunto
affixed in the presence of



[Signature]
[Signature]
[Signature]

[Signature]
Director

ENCUMBRANCES REFERRED TO.

and correct
The rights of persons under the will of *Henry Thomson* decd. who died 27/9/1923 (Book 7) whose will and contents was granted to Emma Elizabeth Le Croisette Thomson, Cecil Percy Thomson and the Trustees Executors and Agency Company Ltd on 8/3/1924.
The rights of the respective franchisees under contracts of sale No 4449451 to 4449457 (with sublease) and 445804 in the Deeds Book of the New Zealand Land.

[Signature]
13/4/31

MEMORIAL OF INSTRUMENT.

1473391

NATURE OF INSTRUMENT	TIME OF ITS PRODUCTION FOR REGISTRATION	TO WHOM GIVEN	NUMBER OR SYMBOL THEREON
TRANSFER AS TO PART	THE 29 th DAY OF December 1931	Reid Investments Proprietary Limited	1473391

Empire
ASSISTANT REGISTRAR OF TITLES.

I CERTIFY THAT A MEMORIAL OF THE WITHIN INSTRUMENT WAS ENTERED AT THE TIME LAST MENTIONED IN THE REGISTER BOOK VOL. 5599 FOL. 1119674

Empire
ASSISTANT REGISTRAR OF TITLES.

SEE TRUSTEES EXECUTORS & AGENCY CO. LTD. AND OTHERS

DATED 1931

BLAKE & RIGGALL

TRANSFER

REID TRUST PTY. LTD.

- to -

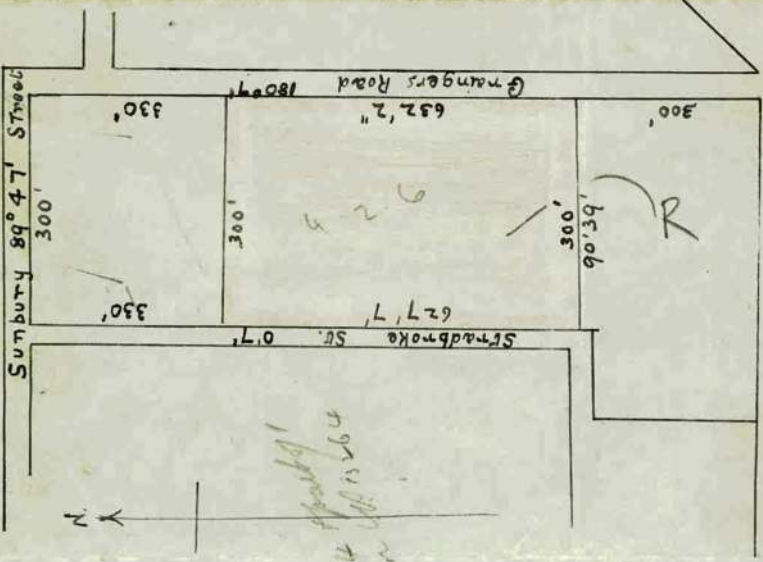

Measurements in feet & inches.

Plot 14 of 15 1931

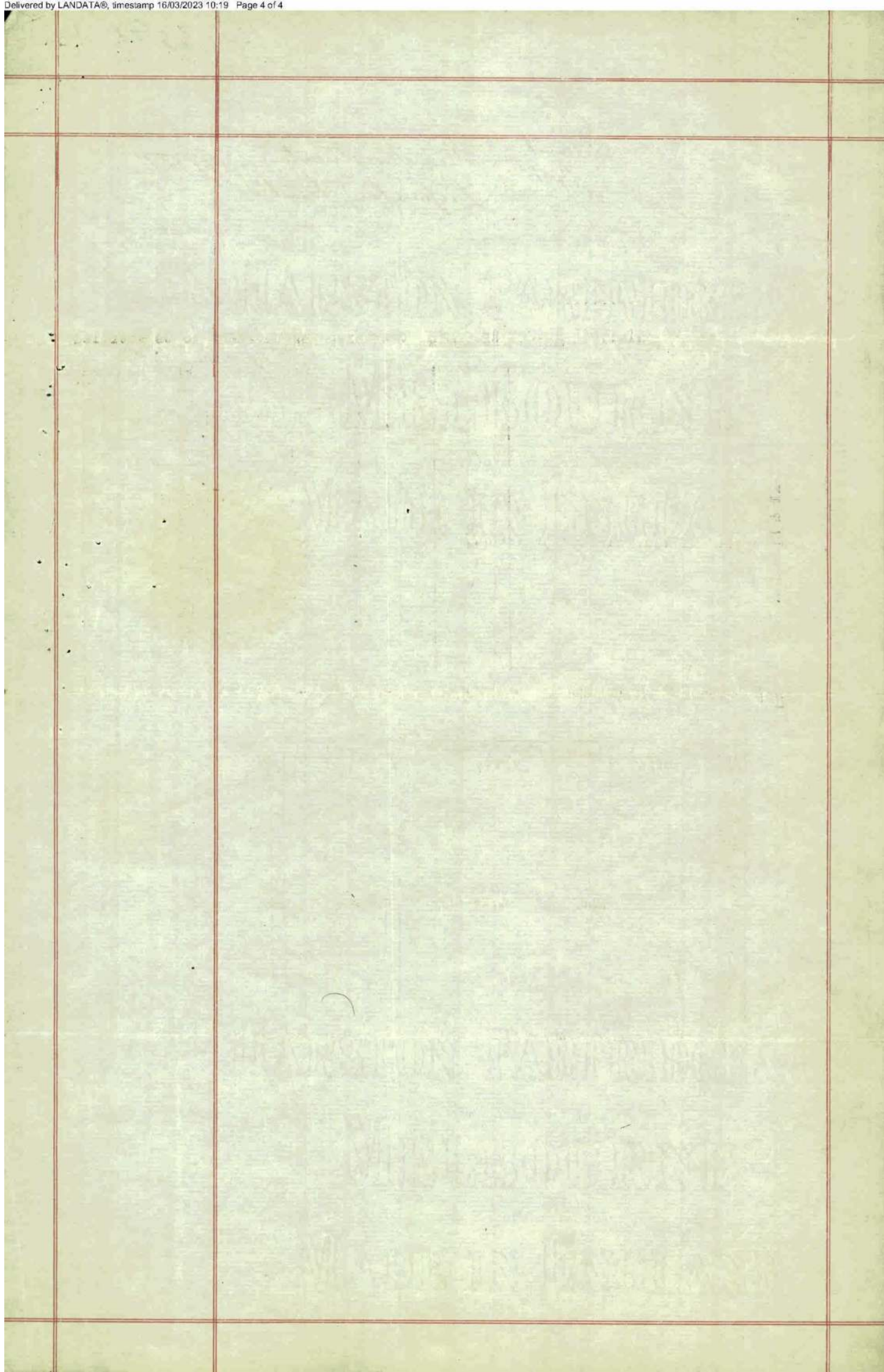

17/11

3558251

P17
141

1640740



WHITING & BYRNE

VICTORIA

TRANSFER OF LAND.

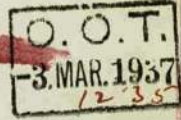

Council of Sub.
5539/675 pt. (Sub.)
5871-083 pt. (Sub.)
2 ac. 1 r. 4 p.
King pt. Lot One on
L.P. 13264/1 being pt.
C.O. 5 Dec. 13
Mr. E. P. Paw
City Bourke
Sub - the cool heron
A.P.
6/4/37

Edwards
12/4/37

WE, EMMA ELIZABETH Le CROISSETTE THOMSON of "Craigellachie" Orrong Road, East St. Kilda, Widow, CECIL PERCY THOMSON of Little Collins Street, Melbourne, Agent, and THE TRUSTEES - EXECUTORS AND AGENCY COMPANY LIMITED of Collins Street, Melbourne, (as to one equal undivided part or share) and --- R. W. KENNEDY PROPRIETARY LIMITED of Stalbridge Chambers, 443 Little Collins Street, Melbourne, (as to the other equal --- undivided part or share) being registered as the proprietors of an estate in fee simple in the land hereinafter described --- subject to the encumbrances notified hereunder in consideration of the sum of TWO THOUSAND AND FIFTY-FIVE POUNDS (£2055) --- paid to us in the respective shares to which we are respectively entitled by JAMES FLOOD PROPRIETARY LIMITED of 320 St. Kilda Road, Melbourne, DO HEREBY TRANSFER to the said James Flood Proprietary Limited All Our estate and interest in ALL THAT piece of land delineated and colored red on the map hereon --- being part of Crown Allotment 5, Section 13 at West Footscray, Parish of Cut Paw Paw, County of Bourke and being part of the land comprised in Certificates of Title Volume 5599 Folio 1119675 and Volume 5871 Folio 1174083 LAND the said James Flood --- Proprietary Limited in consideration of the foregoing transfer

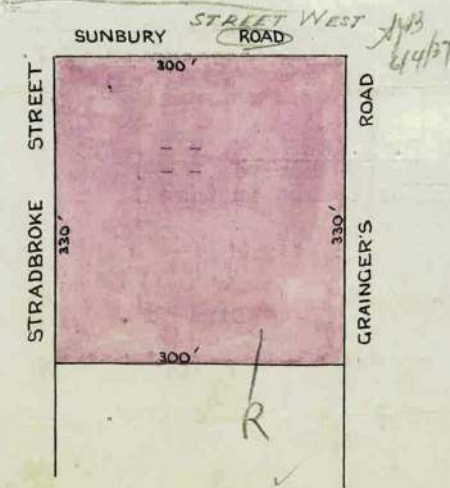

The measurements are in feet.

for itself its successors and transferees registered proprietor or proprietors for the time --- being of the land transferred DOTH HEREBY COVENANT with the said Emma Elizabeth Le Croisette Thomson, Cecil Percy Thomson, The Trustees Executors and Agency Company Limited and R. W. Kennedy Proprietary Limited and their

IMAGED

aug 1937
12/37/8650
a.m.m.
29-437

transferees registered proprietor or proprietors for the time -
being of the land remaining untransferred in the said Certificates
of Title that the said James Flood Proprietary Limited will not
carry on quarrying operations on the said land hereby transferred
or any part thereof or take or remove any marl stone gravel or
sand therefrom except for the purpose of laying the foundations
of any buildings to be erected on the said land or to be used in
erection of such buildings or for the purpose of installing - -
storage tanks AND the said James Flood Proprietary Limited
Hereby requests that the foregoing covenant shall be notified as
an encumbrance on the Certificate of Title to issue in respect of
the land hereby transferred.

DATED the 4th day of February One - -
thousand nine hundred and thirty-seven.

SIGNED in Victoria by the said EMMA - -) *E. G. L. Thomson*
ELIZABETH Le CROISSETTE THOMSON - -)
in the presence of :)
Donald K. Thomson
Real Estate Agent
423 Lat Collins St. C.

SIGNED in Victoria by the said CECIL -) *Cecil P. Thomson*
PERCY THOMSON in the presence of :)
Donald K. Thomson

THE COMMON SEAL of THE TRUSTEES - -)
EXECUTORS AND AGENCY COMPANY LIMITED)
was hereto affixed by authority of)
the Board of Directors)

7
CCM

CCM
Director.

E. J. Druggo
Assistant
General Manager.

THE COMMON SEAL of R. W. KENNEDY - -)
PROPRIETARY LIMITED was hereto - -)
affixed by the authority and in the)
presence of :)

Margaret Kennedy
Director.

M. Kennedy
Secretary.

Appeared before me at Melbourne the ^{4th} day of February One thousand nine hundred and thirty-~~six~~^{seven} DONALD KINGSLEY THOMSON the attesting witness to this instrument and declared that he personally knew EMMA ELIZABETH LE CROISSETTE THOMSON and CECIL PERCY THOMSON the persons signing the same and whose signatures the said DONALD KINGSLEY THOMSON attested; and that the names purporting to be the signatures of the said EMMA ELIZABETH LE CROISSETTE THOMSON and CECIL PERCY THOMSON are their own hand-writing and that they were of sound mind and freely and voluntarily signed such instrument.

[Handwritten signature]

DATED

1937

MRS. E. E. LE CROISSETTE
THOMSON & ORS.

-to-

JAMES FLOOD PROPRIETARY LIMITED.

T R A N S F E R .

WHITING & BYRNE.

MEMORIAL OF INSTRUMENT

NATURE OF INSTRUMENT	TIME OF ITS PRODUCTION FOR REGISTRATION	TO WHOM GIVEN	NUMBER OF SYMBOL THE SON
TRANSFER AS TO PART	THE 3 rd DAY OF March 1937	TO James Flood Proprietary Limited	1640740

[Handwritten signature]

ASSISTANT REGISTRAR OF TITLES*

I CERTIFY THAT A MEMORIAL OF THE WITHIN INSTRUMENT WAS ENTERED AT THE TIME LAST MENTIONED IN THE REGISTER BOOK VOL 5871 FOL 1174083

[Handwritten signature]

ASSISTANT REGISTRAR OF TITLES

THE COMMON SEAL of JAMES FLOOD -)
PROPRIETARY LIMITED was hereto -)
affixed by authority of the - -)
Directors and in the presence of:)



J. Flood

MANAGING DIRECTOR.

ENCUMBRANCES REFERRED TO.

NIL.

J.B. 22/3/37 { The rights of persons under the will and
codicils of Percy Thompson Thomson *J.B. 22/3/37*
who died on the 27th September 1923.
Probate whereof was granted to
Emma Elizabeth Le Coignette Thomson
being Percy Thomson and the Trustees
Executors and Agency Company
limited on the 8th March 1924 *J.B. 22/3/37*



Register Search Statement - Volume 10255 Folio 461

Copyright State of Victoria. No part of this publication may be reproduced except as permitted by the Copyright Act 1968 (Cth), to comply with a statutory requirement or pursuant to a written agreement. The information is only valid at the time and in the form obtained from the LANDATA REGD TM System. None of the State of Victoria, its agents or contractors, accepts responsibility for any subsequent publication or reproduction of the information.

The Victorian Government acknowledges the Traditional Owners of Victoria and pays respects to their ongoing connection to their Country, History and Culture. The Victorian Government extends this respect to their Elders, past, present and emerging.

REGISTER SEARCH STATEMENT (Title Search) Transfer of Land Act 1958

VOLUME 10255 FOLIO 461

Security no : 124105500716M
Produced 19/04/2023 11:48 PM

LAND DESCRIPTION

Land in Plan of Consolidation 167685H.
PARENT TITLE Volume 09904 Folio 600
Created by instrument T752044L 03/07/1995

REGISTERED PROPRIETOR

Estate Fee Simple
Sole Proprietor
WATTYL AUSTRALIA PTY LTD of 48 WALKER ST CANADA BAY NSW 2046
V596969D 20/08/1998

ENCUMBRANCES, CAVEATS AND NOTICES

Any encumbrances created by Section 98 Transfer of Land Act 1958 or Section 24 Subdivision Act 1988 and any other encumbrances shown or entered on the plan or imaged folio set out under DIAGRAM LOCATION below.

DIAGRAM LOCATION

SEE CP167685H FOR FURTHER DETAILS AND BOUNDARIES

ACTIVITY IN THE LAST 125 DAYS

NIL

-----END OF REGISTER SEARCH STATEMENT-----

Additional information: (not part of the Register Search Statement)

Street Address: 40-44 GRAINGERS ROAD WEST FOOTSCRAY VIC 3012

DOCUMENT END

The information supplied has been obtained by Dye & Durham Property Pty Ltd who is licensed by the State of Victoria to provide this information via LANDATA® System. Delivered at 20/04/2023, for Order Number 79104508. Your reference: [20221024] Project Transformer.

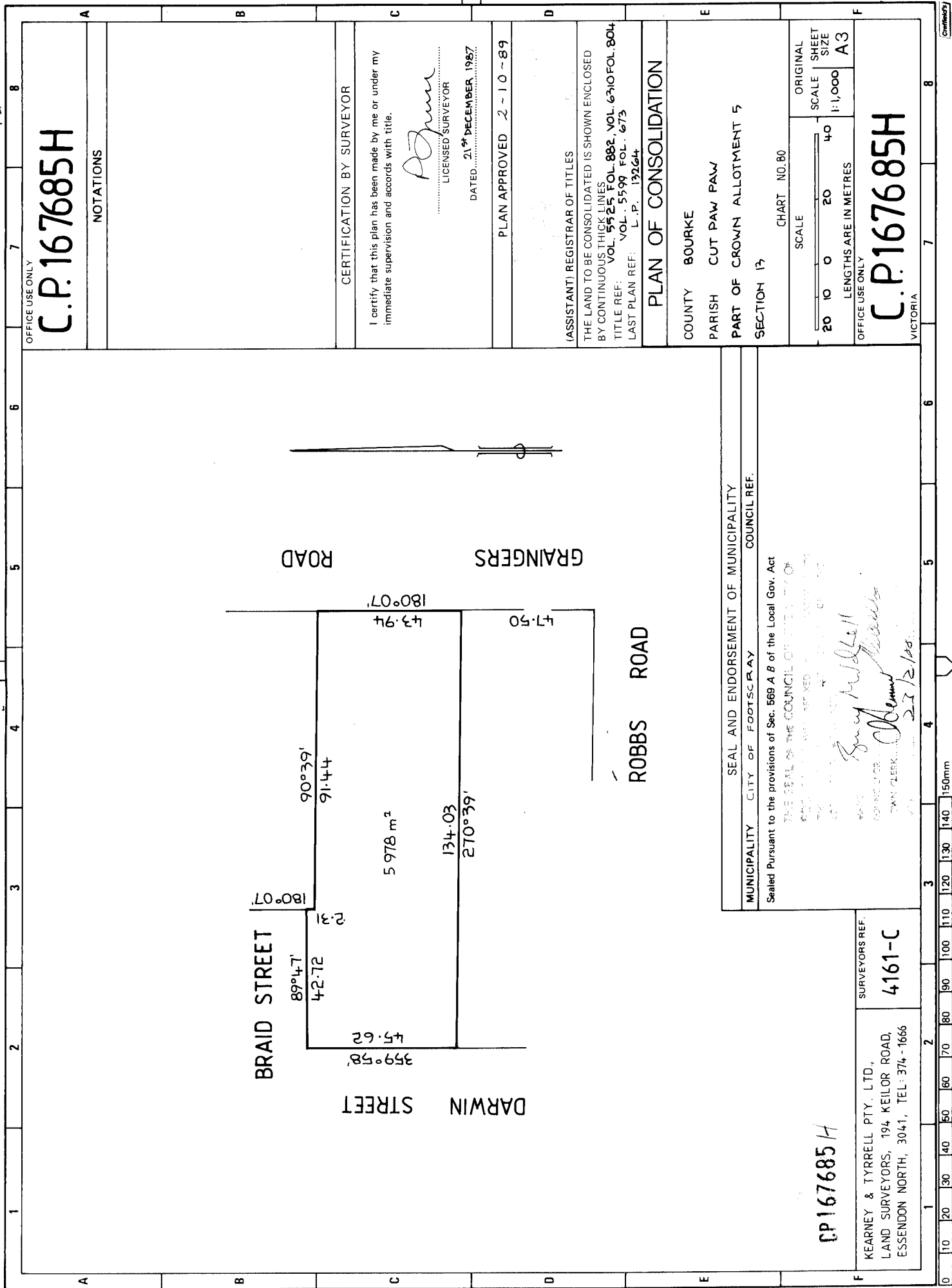

OFFICE USE ONLY
C.P.167685H
 NOTATIONS

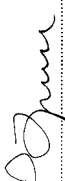
CERTIFICATION BY SURVEYOR
 I certify that this plan has been made by me or under my immediate supervision and accords with title.

 LICENSED SURVEYOR
 DATED 21ST DECEMBER 1987
 PLAN APPROVED 2-10-89

(ASSISTANT) REGISTRAR OF TITLES
 THE LAND TO BE CONSOLIDATED IS SHOWN ENCLOSED BY CONTINUOUS THICK LINES
 TITLE REF: VOL. 5525 FOL. 882, VOL. 6310 FOL. 804
 LAST PLAN REF: VOL. 5599 FOL. 673 L.P. 132644

PLAN OF CONSOLIDATION

COUNTY BOURKE
 PARISH CUT PAW PAW
 PART OF CROWN ALLOTMENT 5
 SECTION 17
 CHART NO. 80

SCALE
 20 10 0 20 40
 LENGTHS ARE IN METRES
 ORIGINAL SCALE 1:1,000
 SHEET SIZE A3

OFFICE USE ONLY
C.P.167685H
 VICTORIA

SEAL AND ENDORSEMENT OF MUNICIPALITY
 MUNICIPALITY CITY OF FOOTSCRAY COUNCIL REF.

Sealed Pursuant to the provisions of Sec. 569 A B of the Local Gov. Act

THE SEAL OF THE COUNCIL OF THE CITY OF FOOTSCRAY

Signature of Council Clerk
 TOWN CLERK
 23/12/88

KEARNEY & TYRRELL PTY. LTD.,
 LAND SURVEYORS, 194 KEILOR ROAD,
 ESSENDON NORTH, 3041, TEL: 374-1666
 SURVEYORS REF. **4161-C**

CP167685H



Continued